

Welcome

Mahon Park Improvements



Mahon Park is one of the City's largest and oldest parks and has a well-established history in both sports and its natural setting.

Following completion of renovations to Fen Burdett Stadium and the track and field, focus has shifted to renovating and revitalizing the west corner of the park, site of the former horseshoe club facility.

The aging building and horseshoe pitches are scheduled for removal and the City is asking the community to help guide future improvements and provide feedback on design ideas. This is the second public meeting presenting a final design concept developed from community feedback documented from the first public meeting.

Survey Results

Open House #1 was held in September 2018. There was an excellent initial response to the project with a total of 255 questionnaires completed, including 171 online submissions and 84 received in paper form.

Activities

The graph below shows the number of positive responses for the various park elements from the 1st Open House:

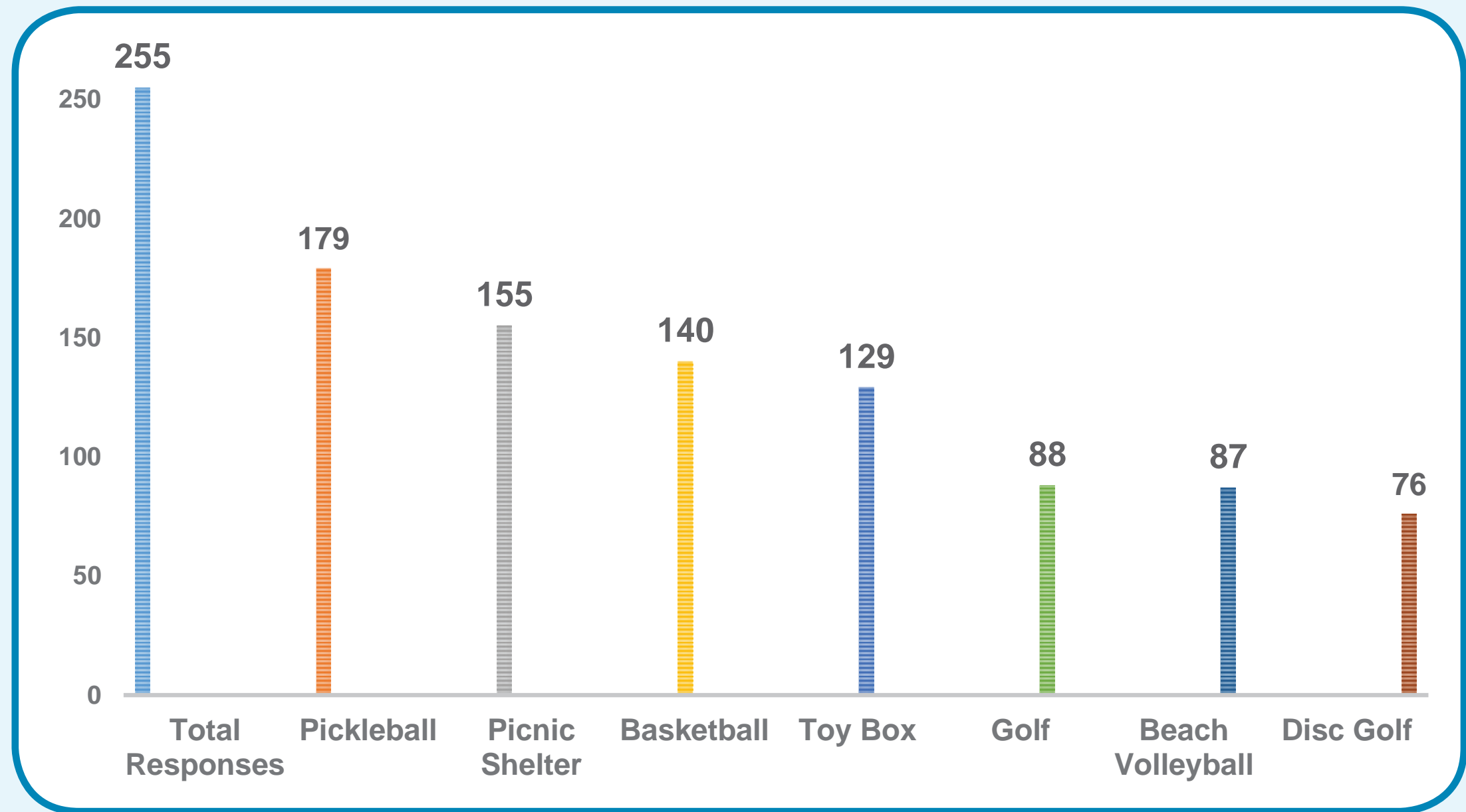

We heard many other suggestions for activities. These are the top 3:



Fenced Dog Area

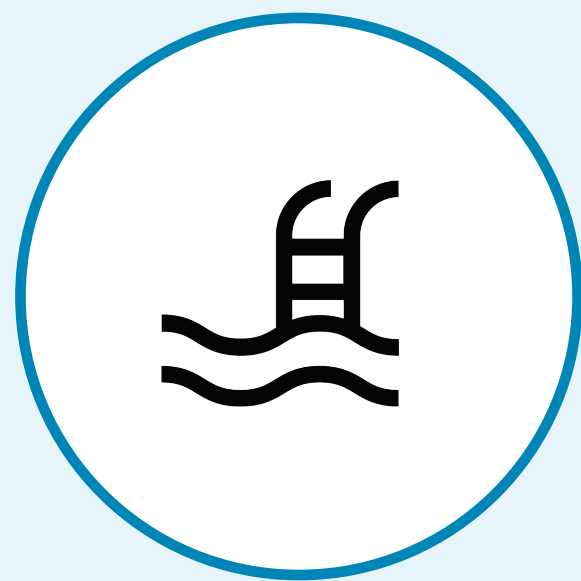

Outdoor Pool



Bike Skills Area /
Community Garden (Tie)

Keep the Existing Trees

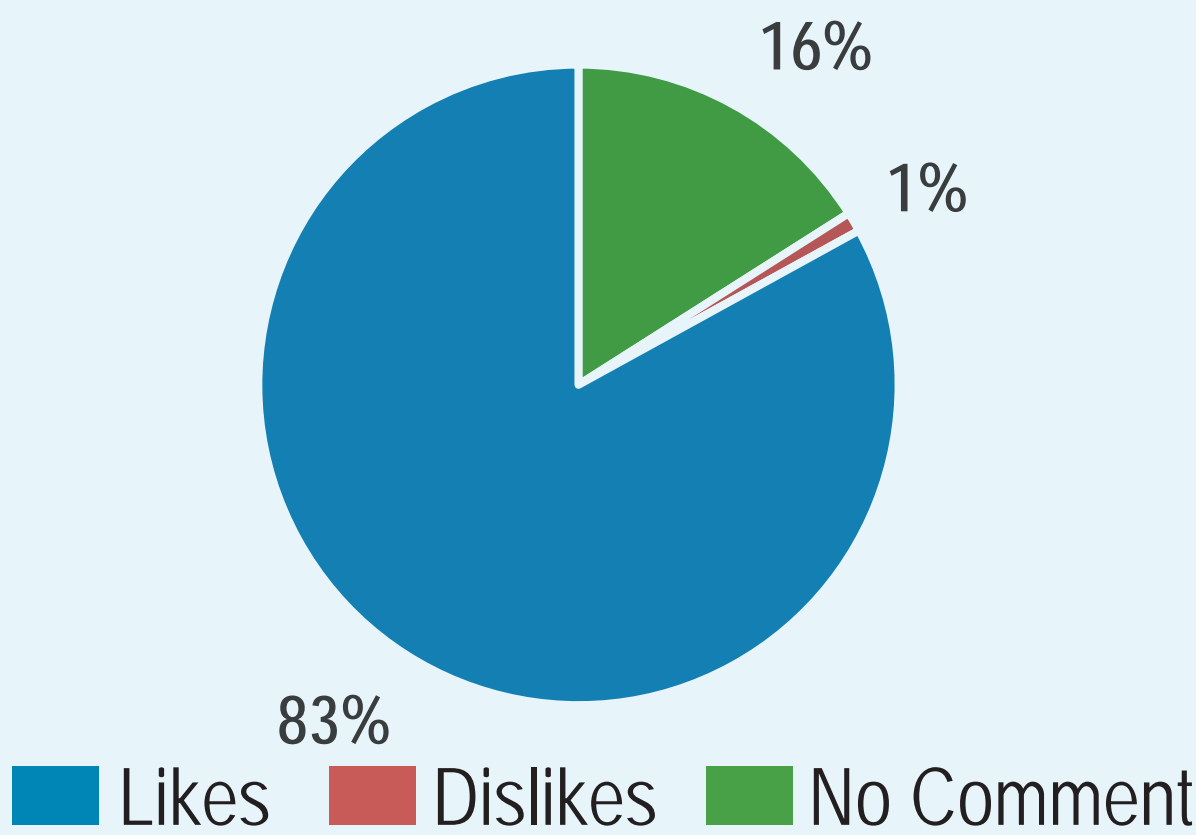

Create Sports Courts for Pickleball and Other Casual Uses

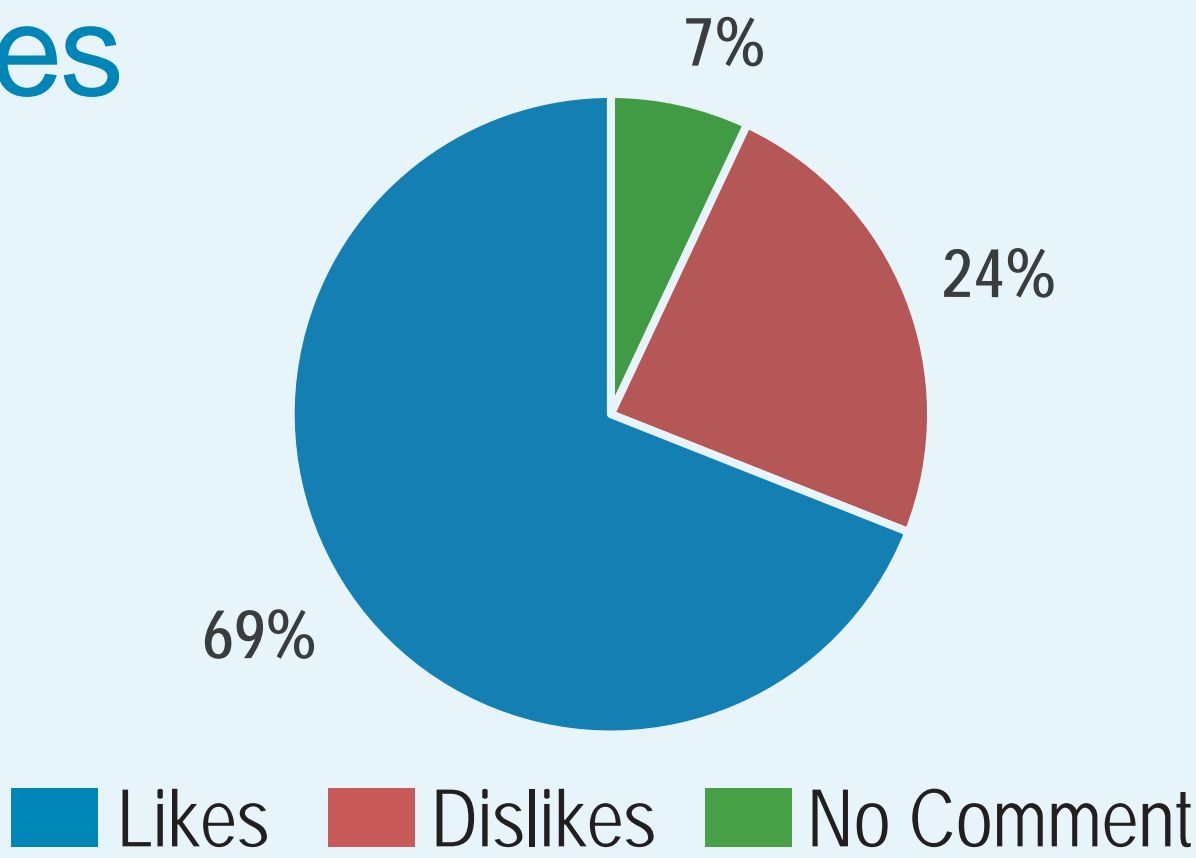

Create a Picnic Shelter

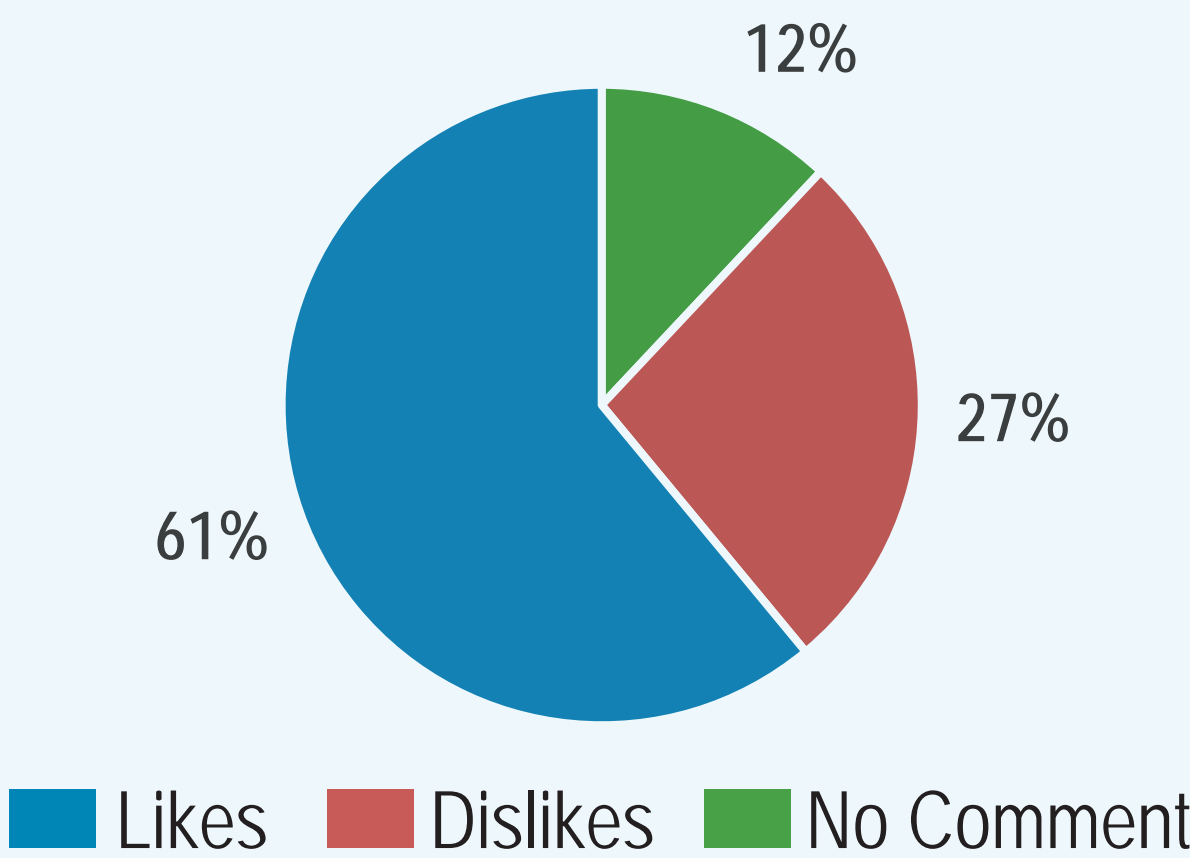

Keep and Improve the Existing Basketball Court

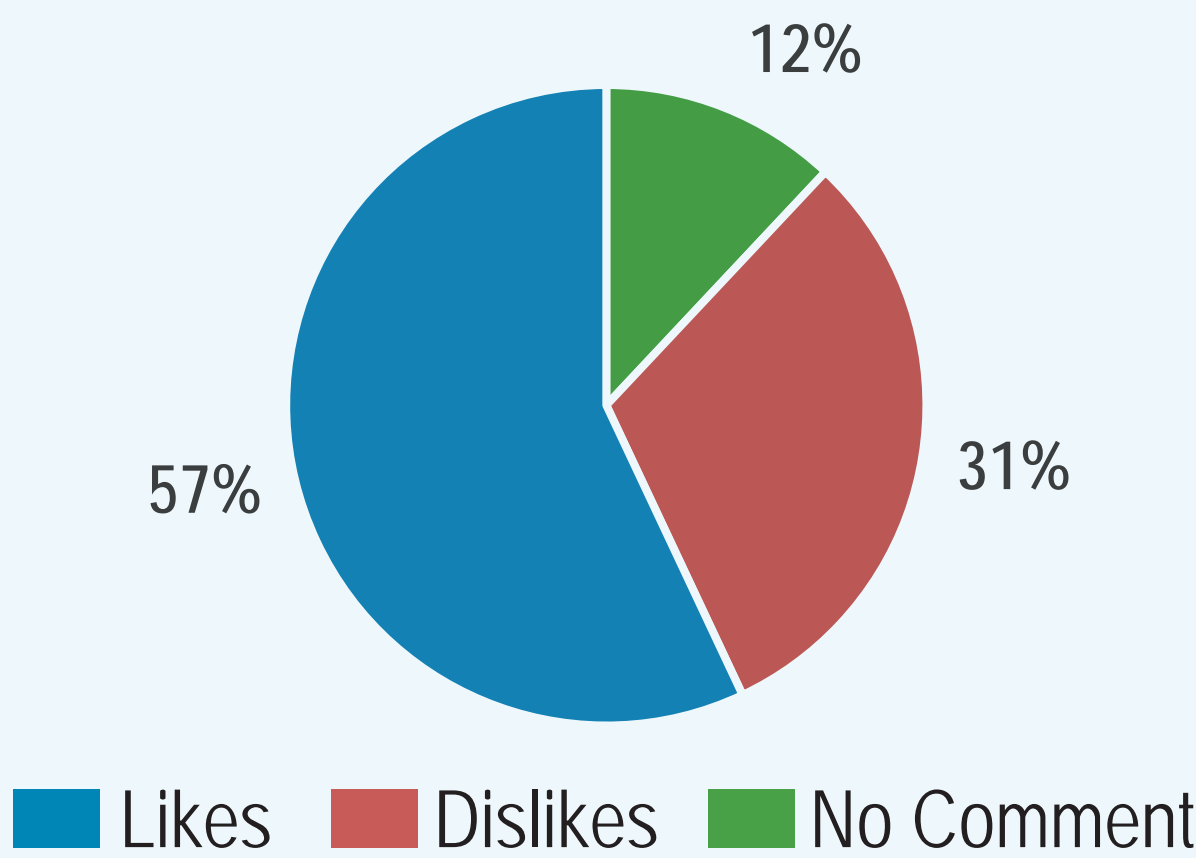

Create a Horticultural Walk, and More Walking Paths

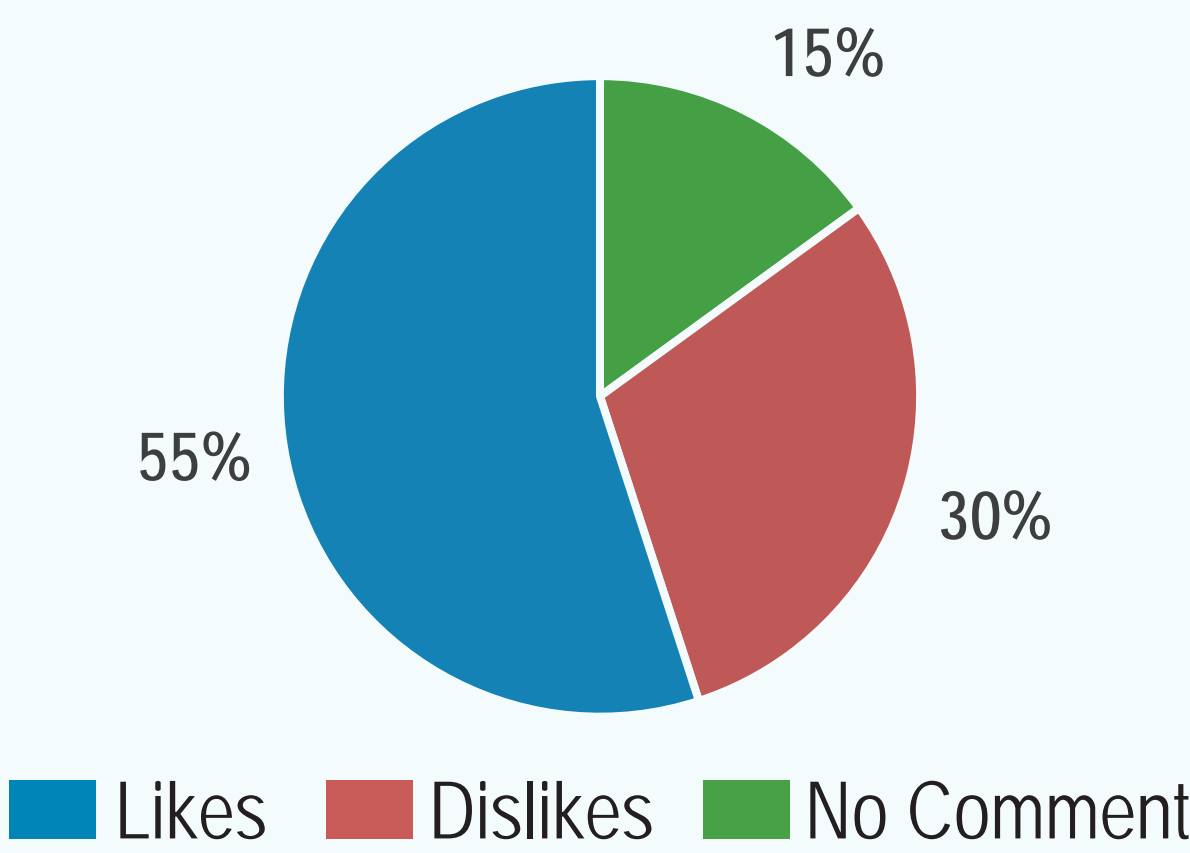

Supply a toy box with free games like bocce, Badminton and croquet

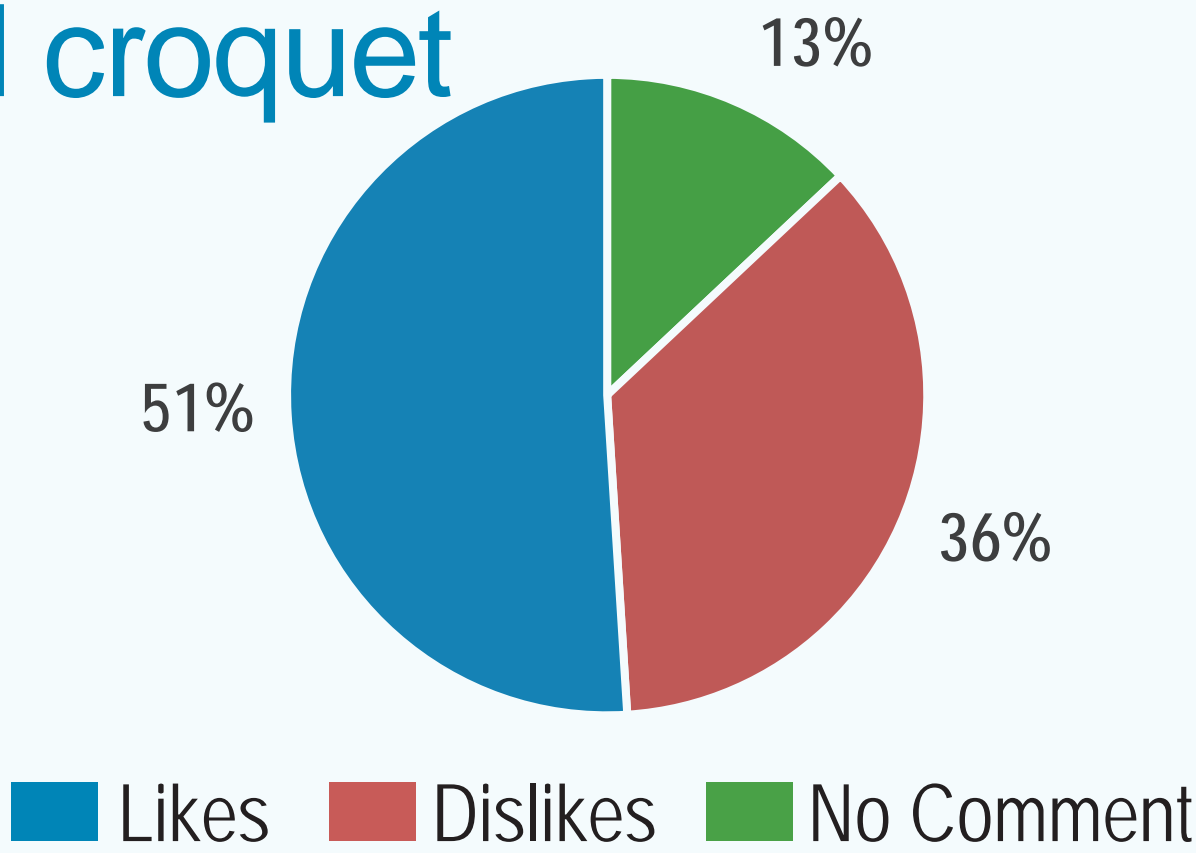

DESIGN CONCEPT

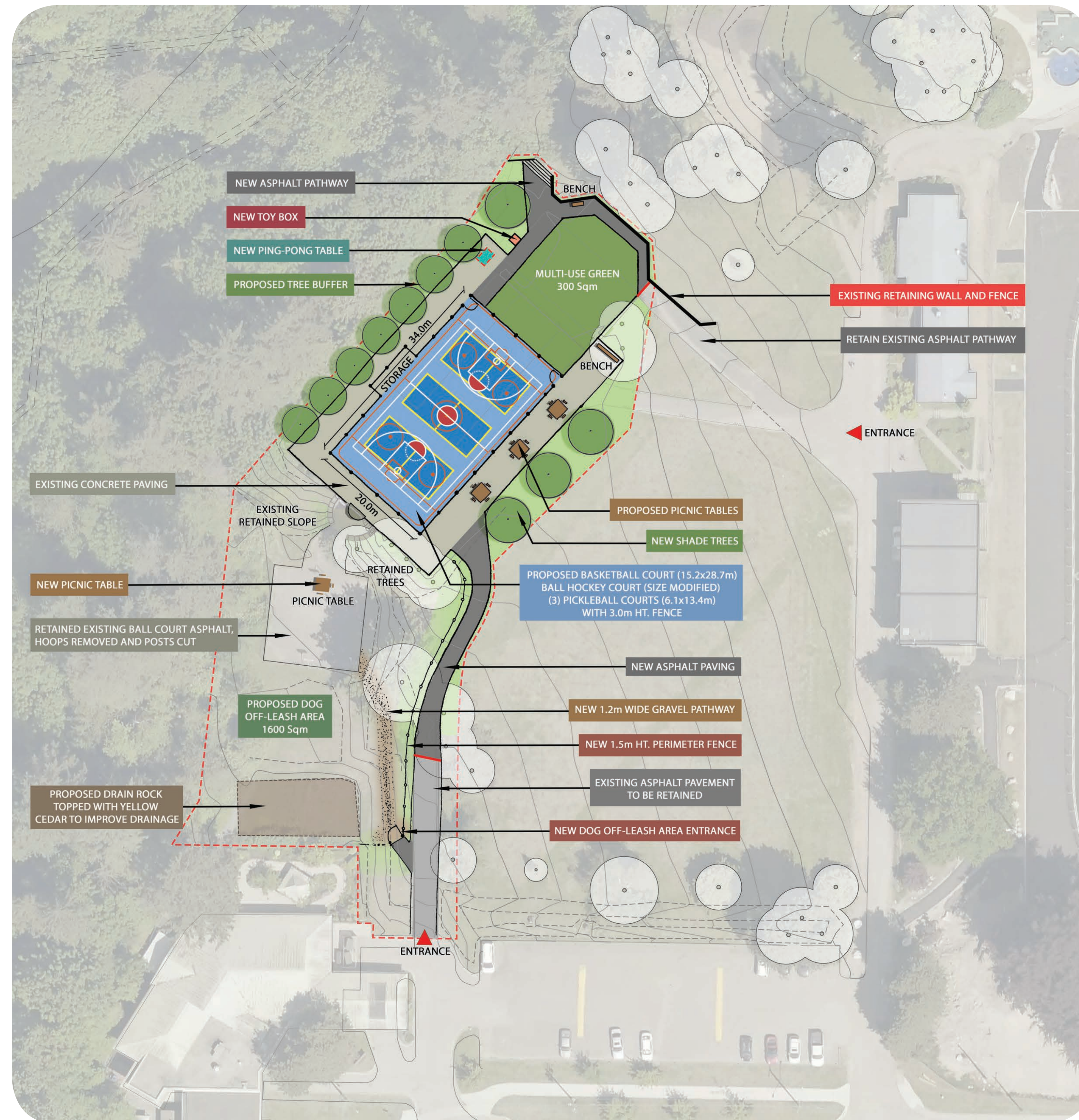

Former Horseshoe / Pool Area - Option 1 may include:

- Multi-use court with new paving to accommodate a full size basketball court, three pickle ball courts, and multi-use artificial turf area for games.

Other Improvements may include:

- A new multi-use artificial turf area to accommodate family games, bocce, yoga, exercise and other informal activities.
- Picnic tables at the open grass area to facilitate picnicking and other social gatherings.
- Shade trees for accent, shade and buffer between activity areas.
- Proposed fenced dog off-leash area with a picnic table social area at the re-purposed basketball court.
- Potential to include a new ping-pong table.

Precedent Images



PICKLEBALL COURTS



MULTI-USE ARTIFICIAL TURF AREA



DOG OFF-LEASH AREA



PICNIC TABLES



PING-PONG TABLE



TREE BUFFER

DESIGN - Other Options for Former Horseshoe Pitch / Pool Area

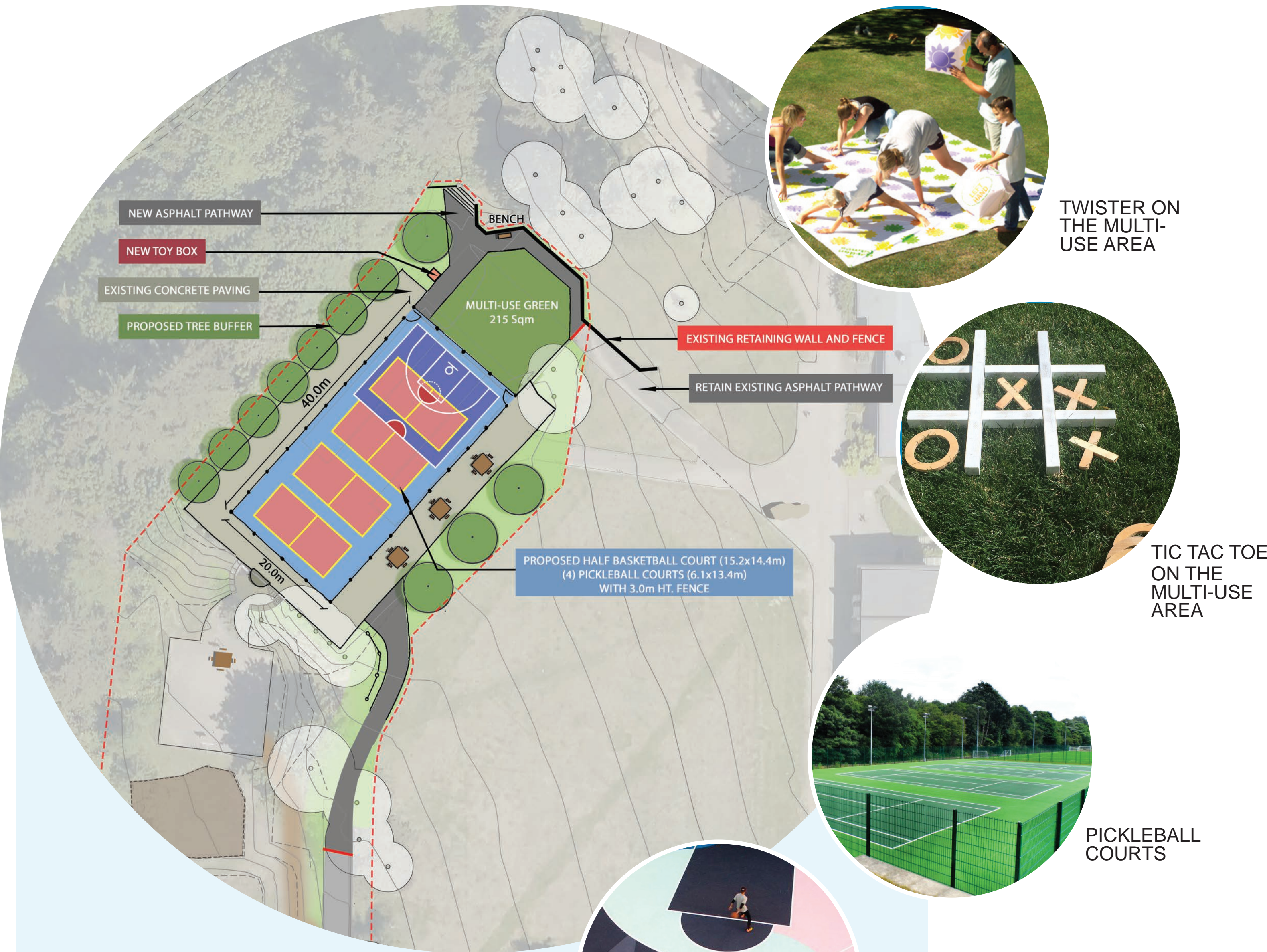

Option 2

SPORTS COURT PROGRAM:
HALF BASKETBALL COURT (15.2x14.4m)
(4) PICKLEBALL COURTS (6.1x13.4m)
WITH 3.0m HT. PERIMETER FENCING

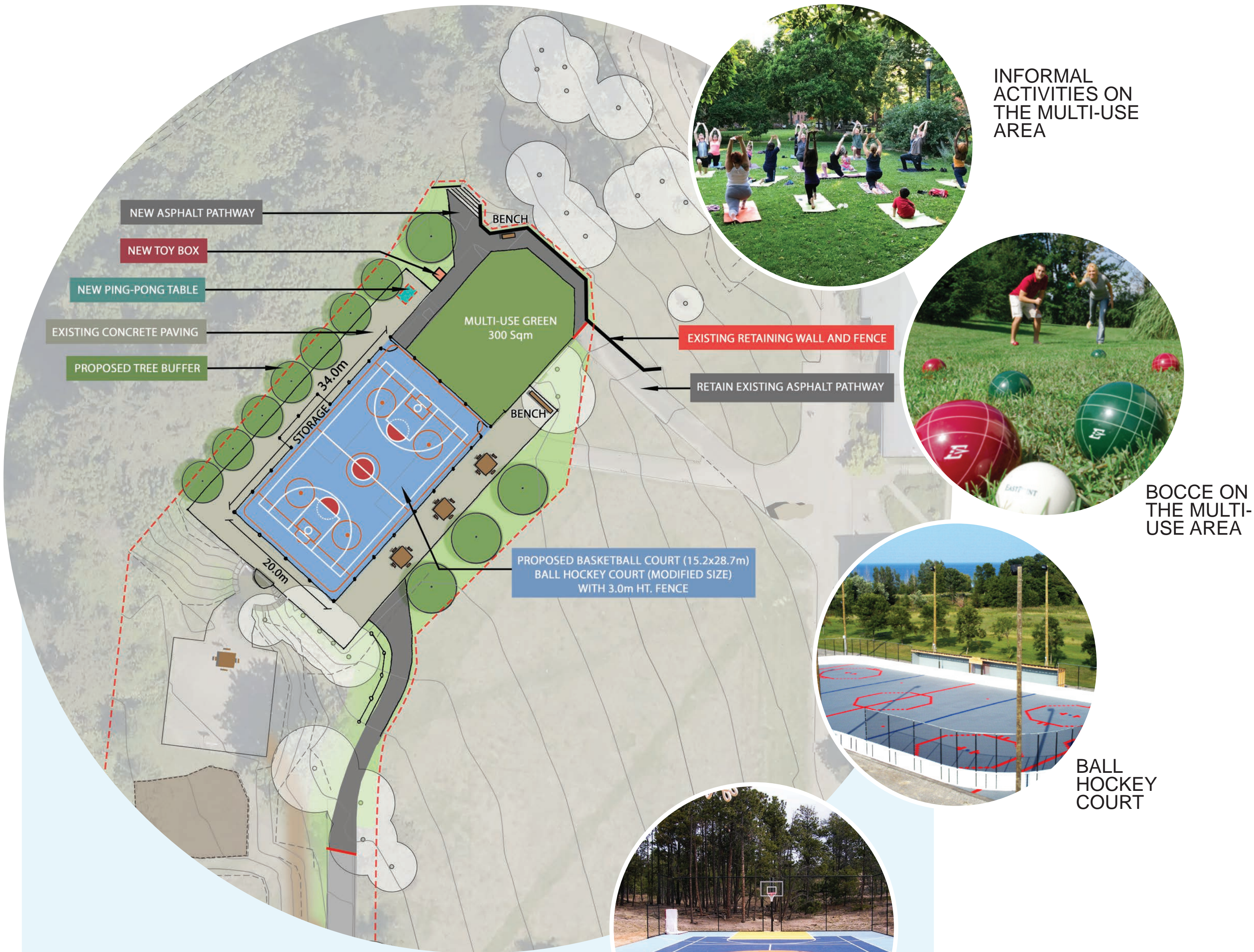

Option 3

SPORTS COURT PROGRAM:
BASKETBALL COURT (15.2x28.7m)
BALL HOCKEY COURT (MODIFIED SIZE)
WITH 3.0m HT. FENCE

Next Steps

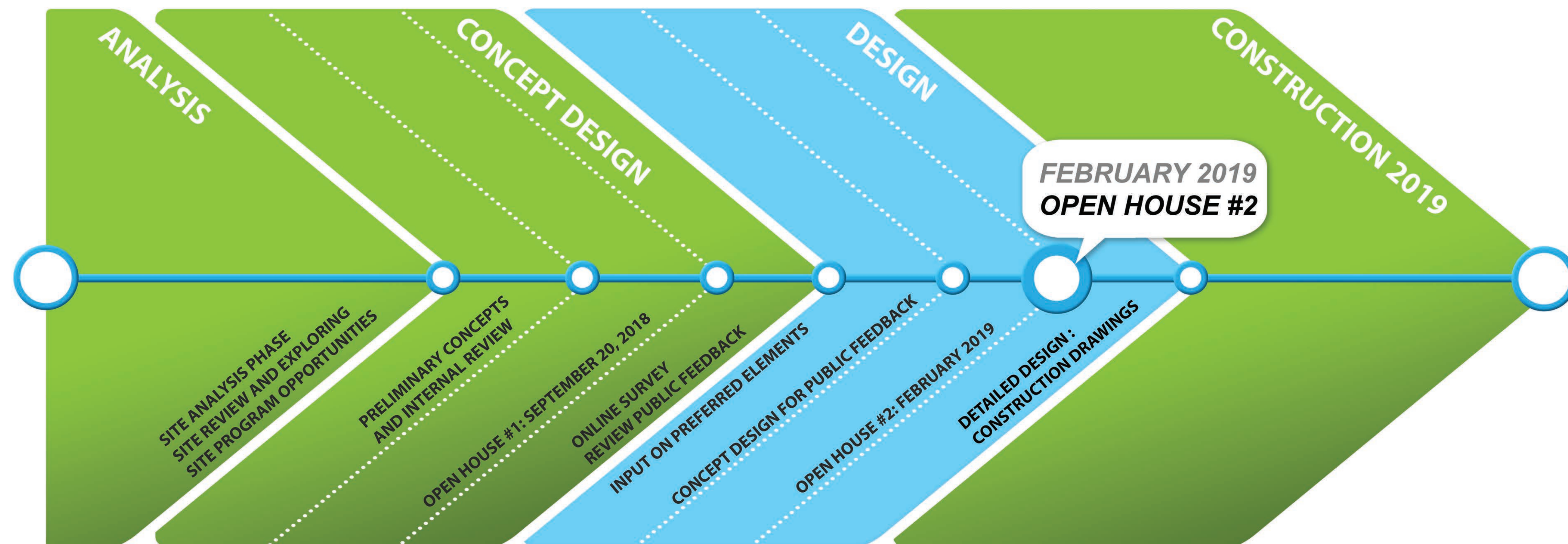

Thank you for attending our open house. We look forward to your feedback!
Please visit our website for updates on this exciting project and to fill out the online questionnaire.

www.cnv.org